

## Ground Floor

Approx. 38.1 sq. metres (409.9 sq. feet)

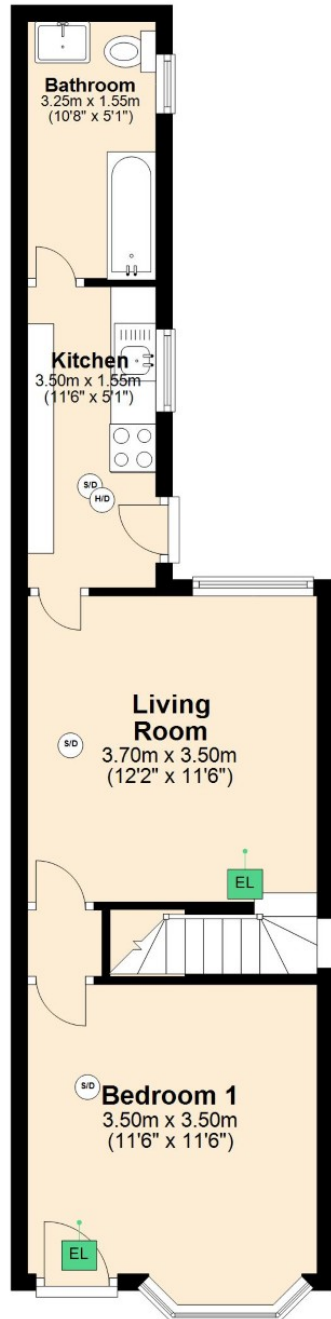

## First Floor

Approx. 32.2 sq. metres (346.7 sq. feet)



### Symbols -

S/D - Smoke Detector

H/D - Heat Detector

E/L - Emergency Lighting

Total area: approx. 70.3 sq. metres (756.6 sq. feet)

**11 Dawlish Road, Selly Oak**