

### Ground Floor

Approx. 64.0 sq. metres (688.7 sq. feet)



### First Floor

Approx. 39.7 sq. metres (427.7 sq. feet)

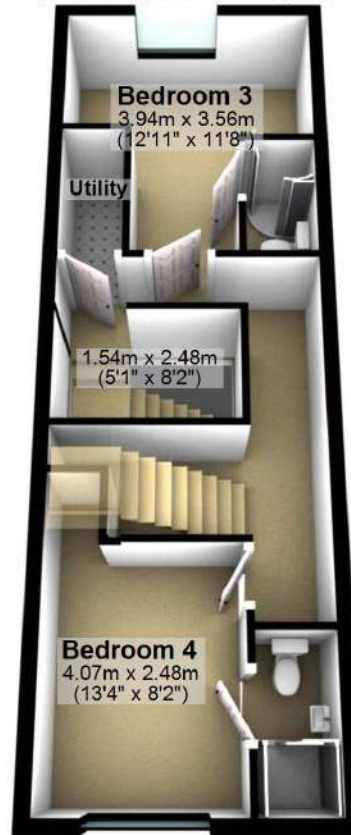

### Second Floor

Approx. 32.5 sq. metres (350.3 sq. feet)

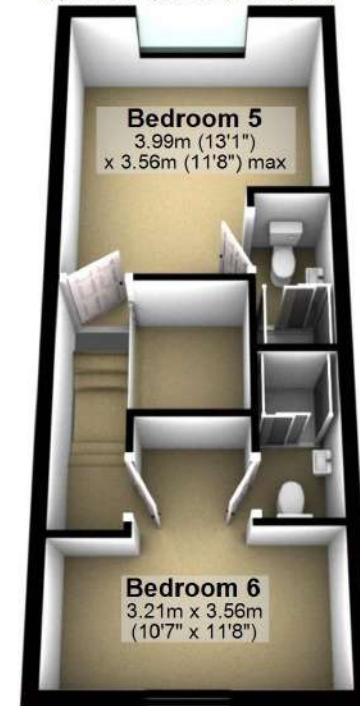

Total area: approx. 136.3 sq. metres (1466.7 sq. feet)

### Ground Floor

Approx. 64.0 sq. metres (688.7 sq. feet)

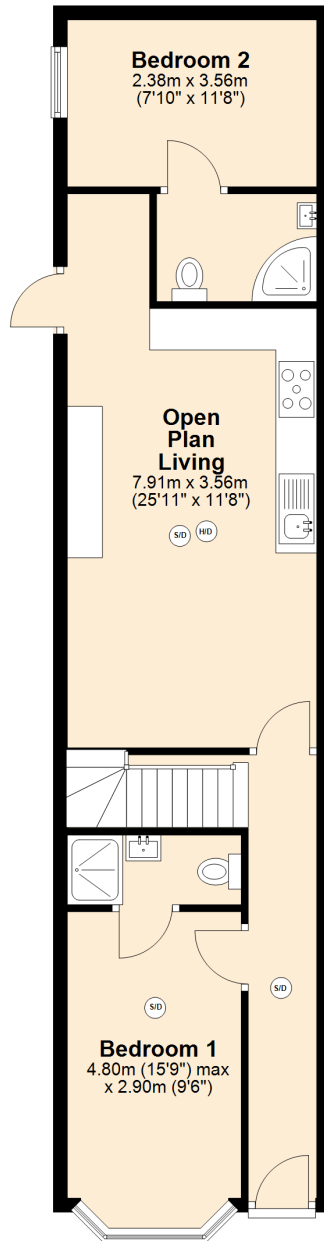

### First Floor

Approx. 39.7 sq. metres (427.7 sq. feet)

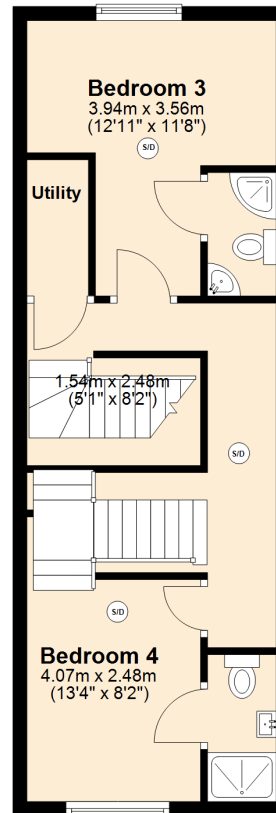

### Second Floor

Approx. 32.5 sq. metres (350.3 sq. feet)

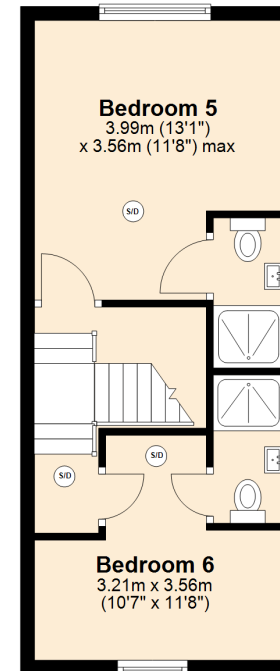

Total area: approx. 136.3 sq. metres (1466.7 sq. feet)

**116 Tiverton Road**