

### Ground Floor

Approx. 55.4 sq. metres (596.3 sq. feet)



### First Floor

Approx. 29.0 sq. metres (312.5 sq. feet)



### Second Floor

Approx. 28.7 sq. metres (308.7 sq. feet)



Total area: approx. 113.1 sq. metres (1217.5 sq. feet)

**Ground Floor**  
Approx. 55.4 sq. metres (596.3 sq. feet)

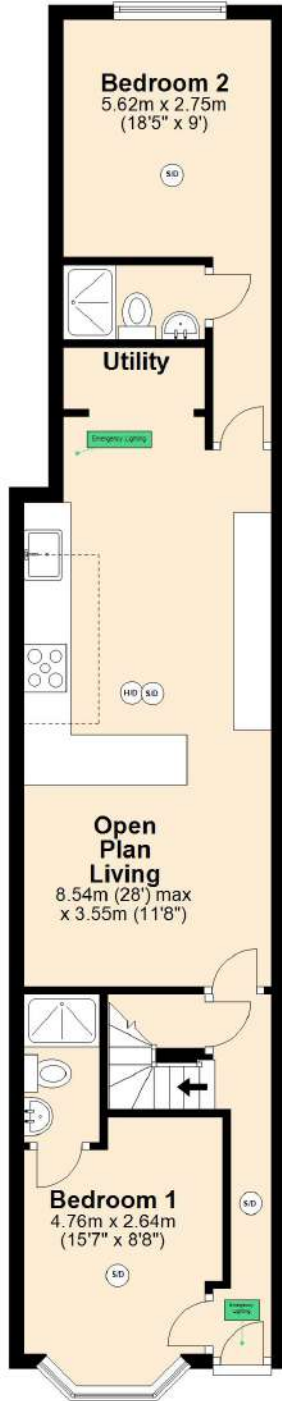

**First Floor**  
Approx. 29.0 sq. metres (312.5 sq. feet)

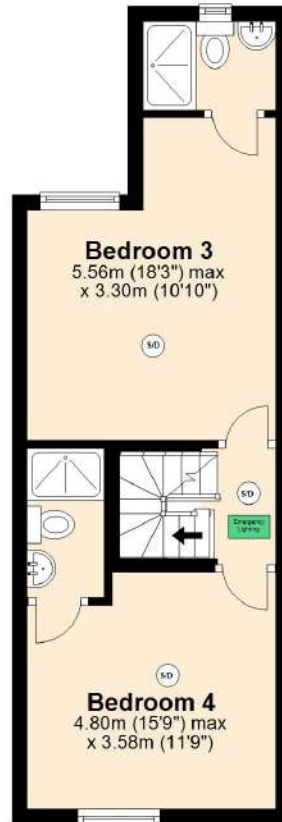

**Second Floor**  
Approx. 28.7 sq. metres (308.7 sq. feet)

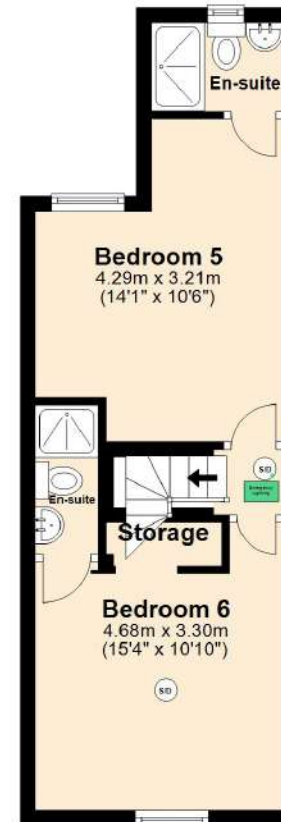

Total area: approx. 113.1 sq. metres (1217.5 sq. feet)

**135 Dawlish Road, Selly Oak**