

Ground Floor

Approx. 29.7 sq. metres (319.6 sq. feet)



First Floor

Approx. 22.6 sq. metres (242.9 sq. feet)

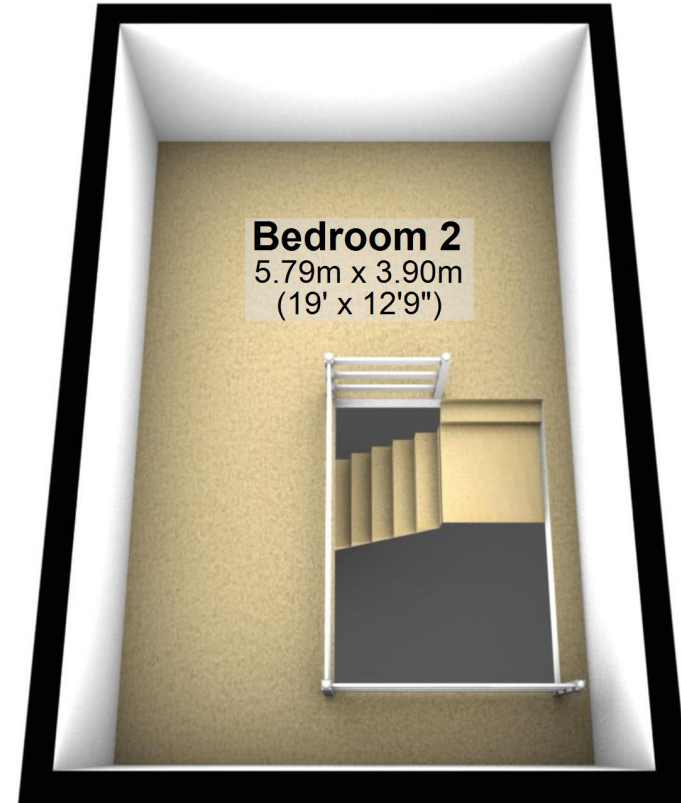

Total area: approx. 52.3 sq. metres (562.4 sq. feet)

Ground Floor

Approx. 29.7 sq. metres (319.6 sq. feet)

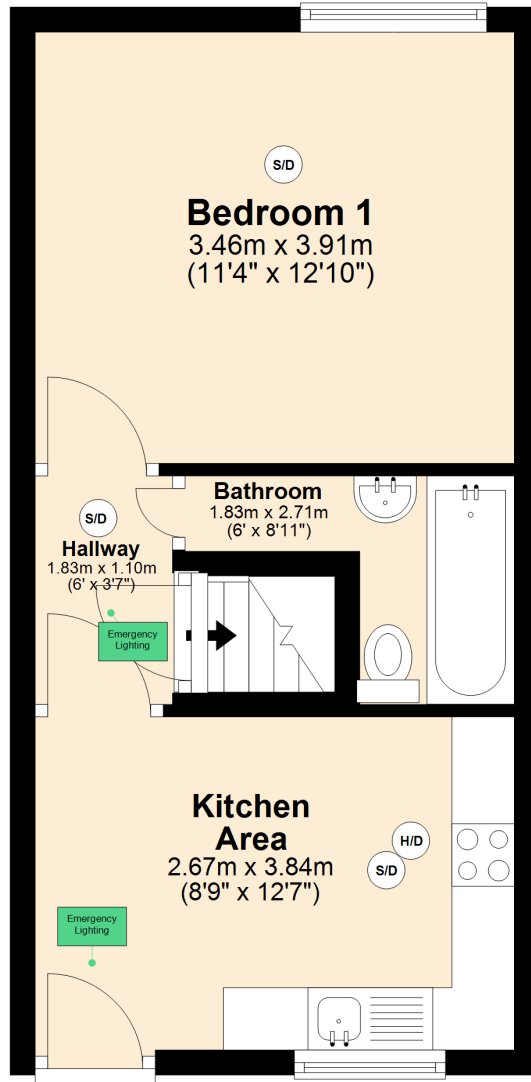

First Floor

Approx. 22.6 sq. metres (242.9 sq. feet)

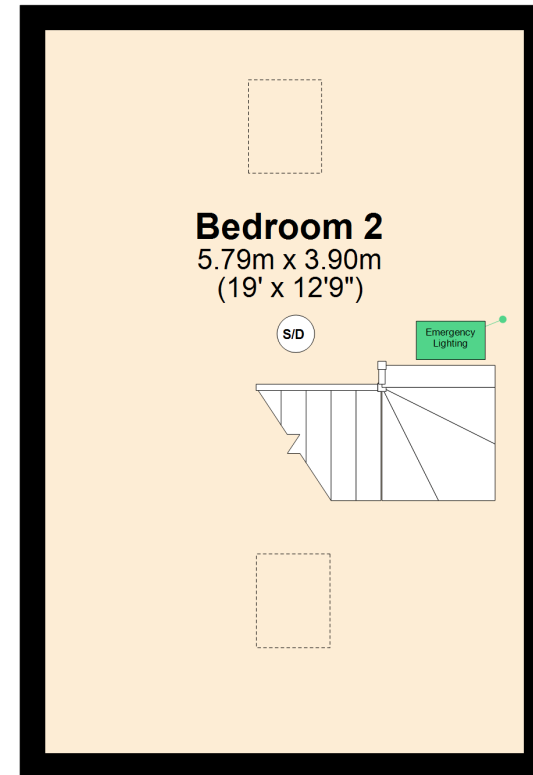

Total area: approx. 52.3 sq. metres (562.4 sq. feet)

19 OAKTREE LANE, Birmingham