

Ground Floor

Approx. 77.7 sq. metres (836.1 sq. feet)



First Floor

Approx. 52.1 sq. metres (560.9 sq. feet)



Second Floor

Approx. 51.8 sq. metres (557.6 sq. feet)



Total area: approx. 181.6 sq. metres (1954.6 sq. feet)

Ground Floor

Approx. 77.7 sq. metres (836.1 sq. feet)

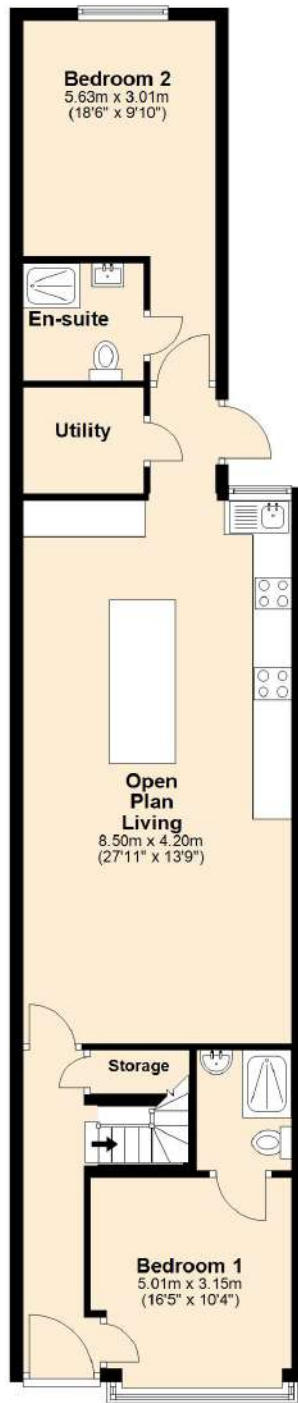

First Floor

Approx. 52.1 sq. metres (560.9 sq. feet)



Second Floor

Approx. 51.8 sq. metres (557.8 sq. feet)



Total area: approx. 181.6 sq. metres (1954.6 sq. feet)

227 Tiverton Road, Selly Oak