

**Ground Floor**  
Approx. 63.4 sq. metres (682.7 sq. feet)



**First Floor**  
Approx. 33.3 sq. metres (358.0 sq. feet)



**Second Floor**  
Approx. 33.2 sq. metres (356.9 sq. feet)



Total area: approx. 129.8 sq. metres (1397.5 sq. feet)

### Ground Floor

Approx. 63.4 sq. metres (682.7 sq. feet)

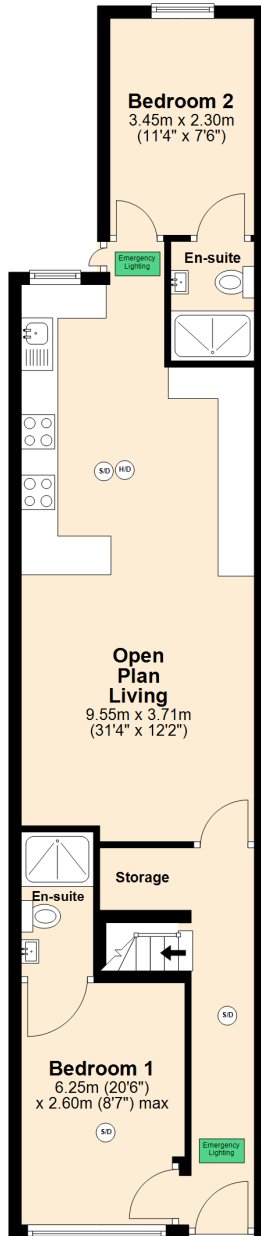

### First Floor

Approx. 33.3 sq. metres (358.0 sq. feet)

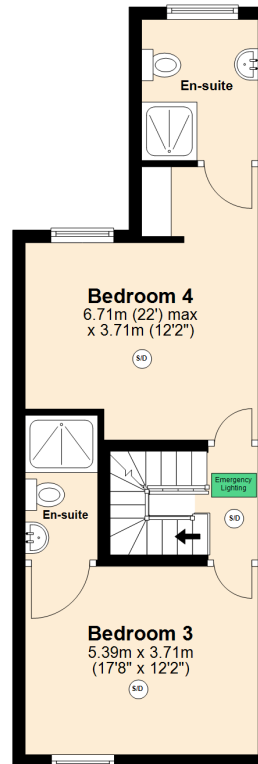

### Second Floor

Approx. 33.2 sq. metres (356.9 sq. feet)

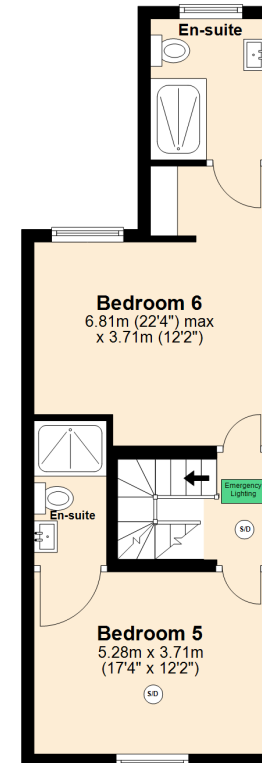

Total area: approx. 129.8 sq. metres (1397.5 sq. feet)  
28 Croydon Road, Birmingham