

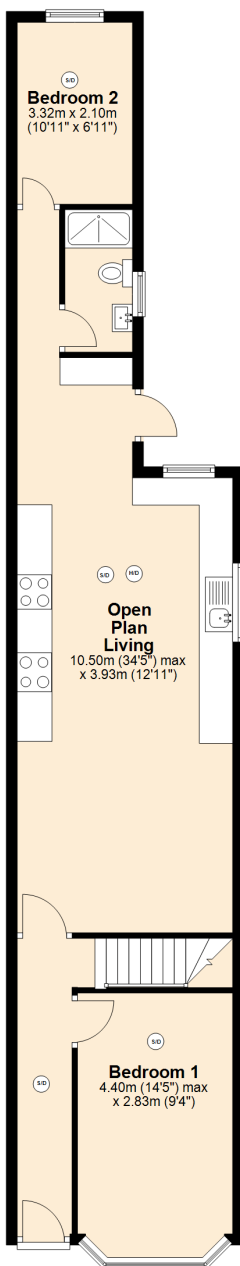

Total area: approx. 141.8 sq. metres (1526.6 sq. feet)

Ground Floor
Approx. 72.2 sq. metres (776.8 sq. feet)



First Floor
Approx. 37.8 sq. metres (406.8 sq. feet)

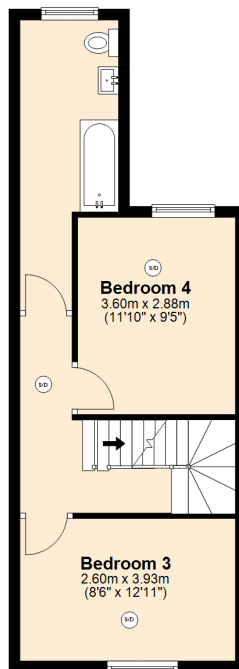

Second Floor
Approx. 31.9 sq. metres (342.9 sq. feet)

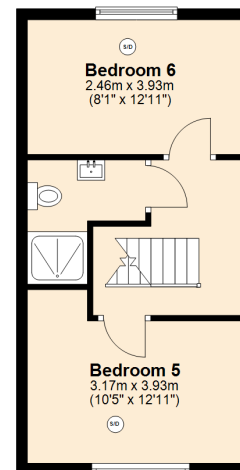

Total area: approx. 141.8 sq. metres (1526.6 sq. feet)
30 Croydon Road