

## Ground Floor

Approx. 46.5 sq. metres (500.1 sq. feet)

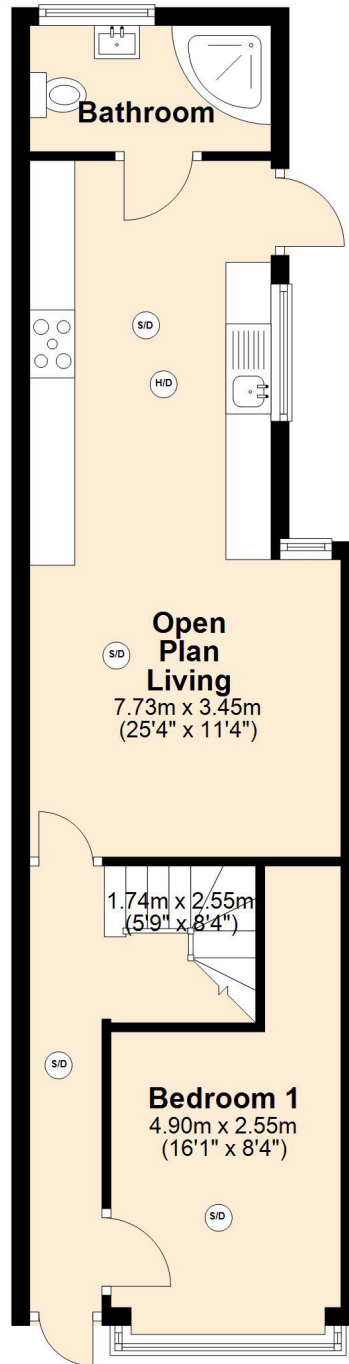

## First Floor

Approx. 32.1 sq. metres (345.9 sq. feet)

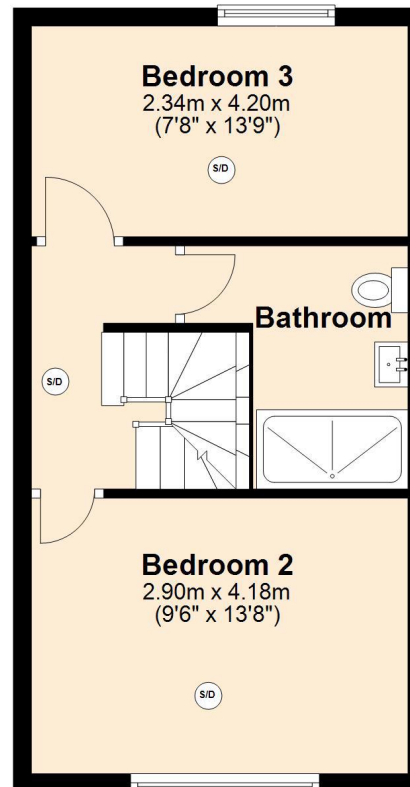

## Second Floor

Approx. 34.7 sq. metres (373.2 sq. feet)

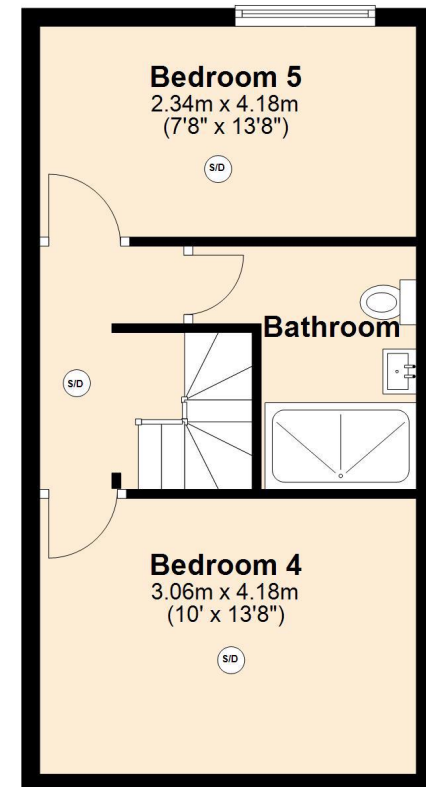

Total area: approx. 113.3 sq. metres (1219.2 sq. feet)

**30 Harrow Road**

## Ground Floor

Approx. 46.5 sq. metres (500.1 sq. feet)

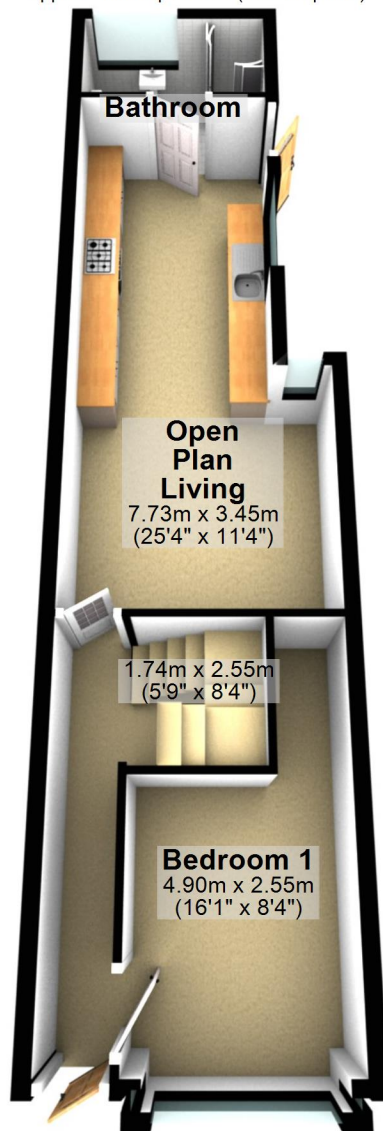

## First Floor

Approx. 32.1 sq. metres (345.9 sq. feet)

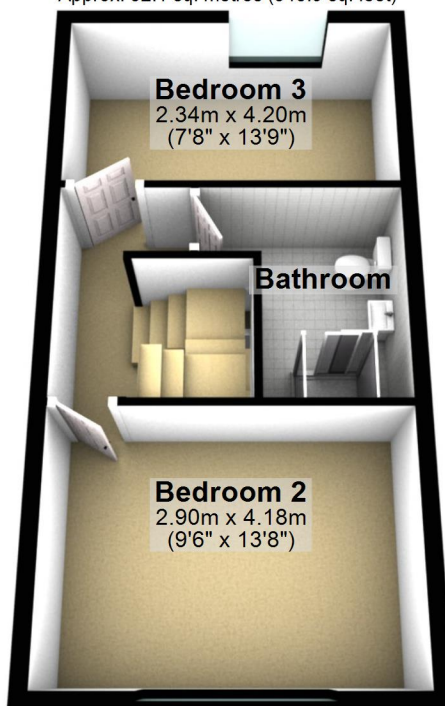

## Second Floor

Approx. 34.7 sq. metres (373.2 sq. feet)

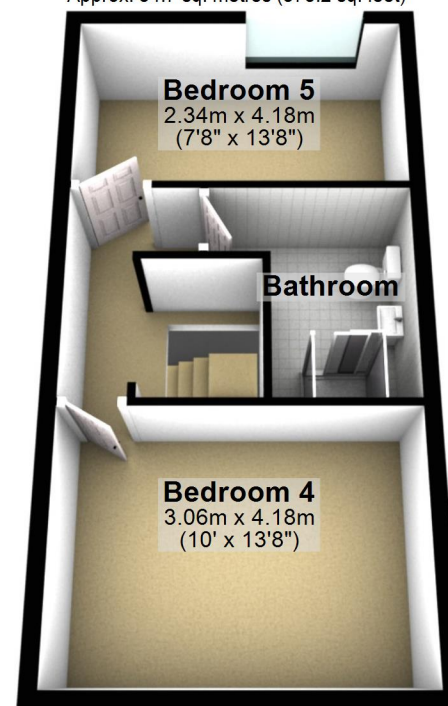

Total area: approx. 113.3 sq. metres (1219.2 sq. feet)