

### Ground Floor

Approx. 43.6 sq. metres (469.3 sq. feet)



### First Floor

Approx. 31.1 sq. metres (334.3 sq. feet)



### Second Floor

Approx. 34.0 sq. metres (365.8 sq. feet)



Total area: approx. 108.6 sq. metres (1169.4 sq. feet)

## Ground Floor

Approx. 43.6 sq. metres (469.3 sq. feet)

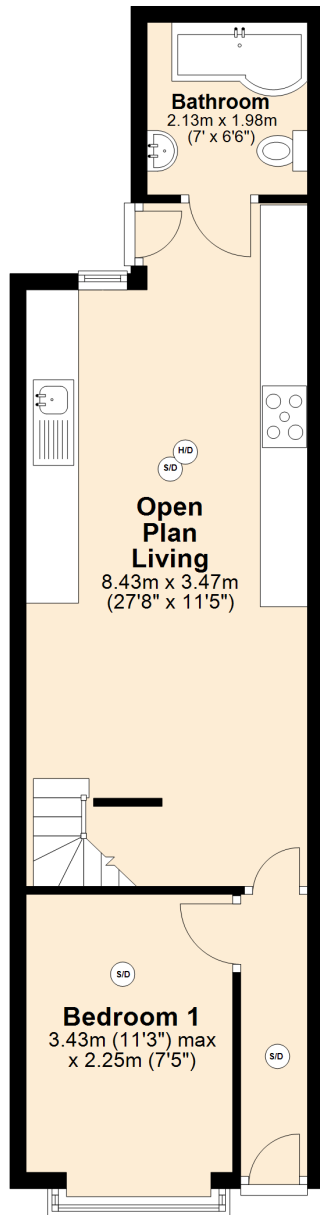

## First Floor

Approx. 31.1 sq. metres (334.3 sq. feet)

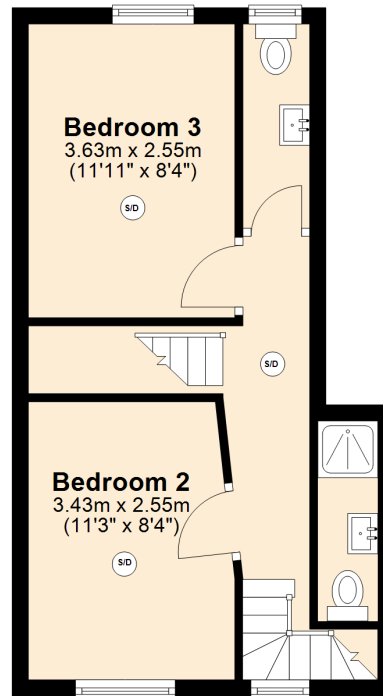

## Second Floor

Approx. 34.0 sq. metres (365.8 sq. feet)

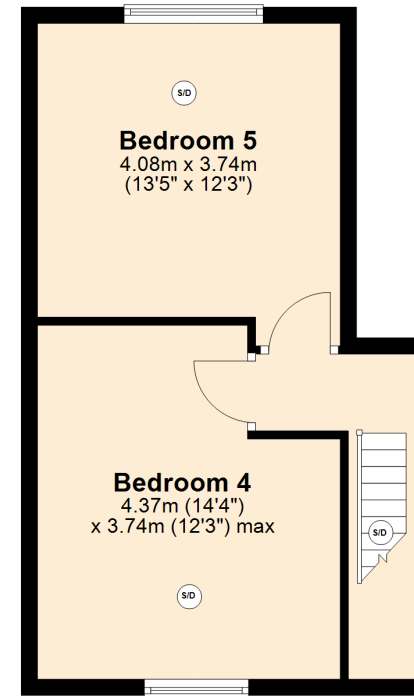

Total area: approx. 108.6 sq. metres (1169.4 sq. feet)

**247 Tiv**